

# How to Connect Your Device to the School's Network

Use this help sheet to access the school's network on your device **N.B. please remember that when connected to the network in this way you understand that your activity will be monitored** in line with the Digital Safety Policy which can be found on the school's website.

First navigate to the school's website [www.lrgs.org.uk](http://www.lrgs.org.uk) and click the key symbol in the top right corner:

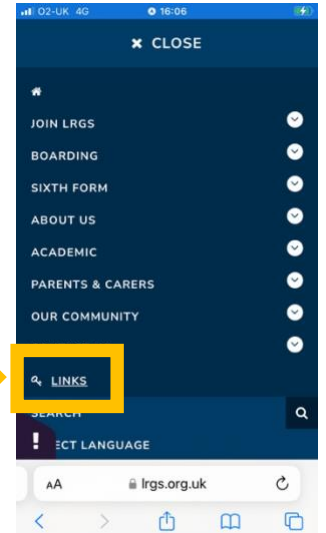
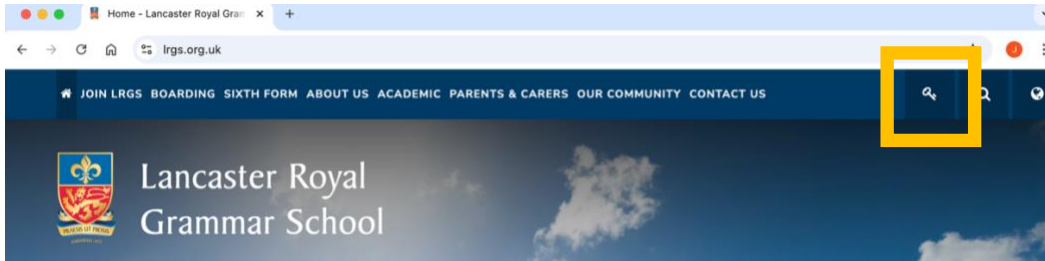

On a mobile it may look more like this:

Then choose 'Wifi Access Certificate':

HOME » SELECT YOUR DESTINATION

## Select your destination

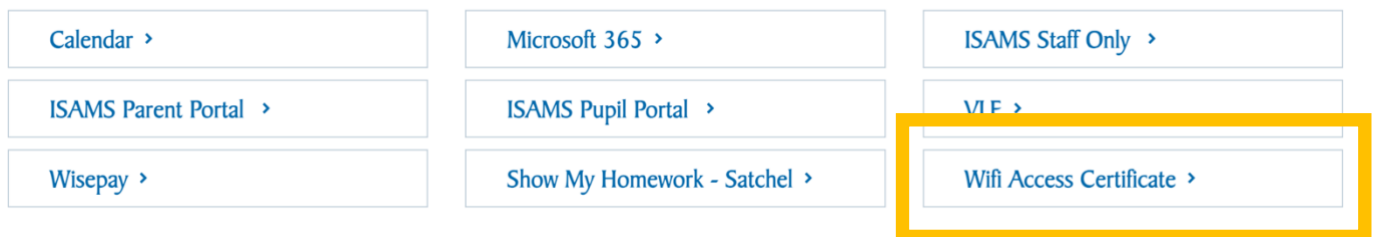

Now download the 'LRGS-CERT Zip File' to your device:

HOME » BOARDING » WI-FI ACCESS CERTIFICATE

## Wi-Fi Access Certificate

Download and extract this zip file to access the LRGS-CERT certificate. You'll need to install it onto your device for access to the school Wi-Fi.

It should be installed to your device's **Trusted Root Certification Authorities** store.

**\*\*Please remember that your internet access is monitored\*\***

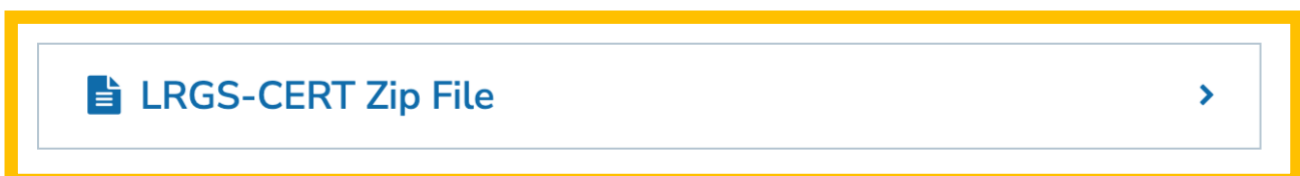

Then install the certificate to any device you want to access the school's network.

# How to Install the Certificate on Your Device

## Steps to Install a Certificate on iPhone

### 1. Download the Certificate:

1. Use Safari to download the certificate file ( .crt , .cer , or .pem ).
2. Tap **Allow** when prompted to download the configuration profile.

### 2. Install the Profile:

1. Open the **Settings** app.
2. Tap **Profile Downloaded** near the top (or go to **General > VPN & Device Management**).
3. Tap **Install** in the top right corner and enter your passcode.
4. Agree to the warning prompts by tapping **Install** again.

### 3. Trust the Certificate (Required for SSL/TLS):

1. Go to **Settings > General > About**.
2. Scroll to the bottom and select **Certificate Trust Settings**.
3. Under "Enable full trust for root certificates," turn on the toggle for the certificate.

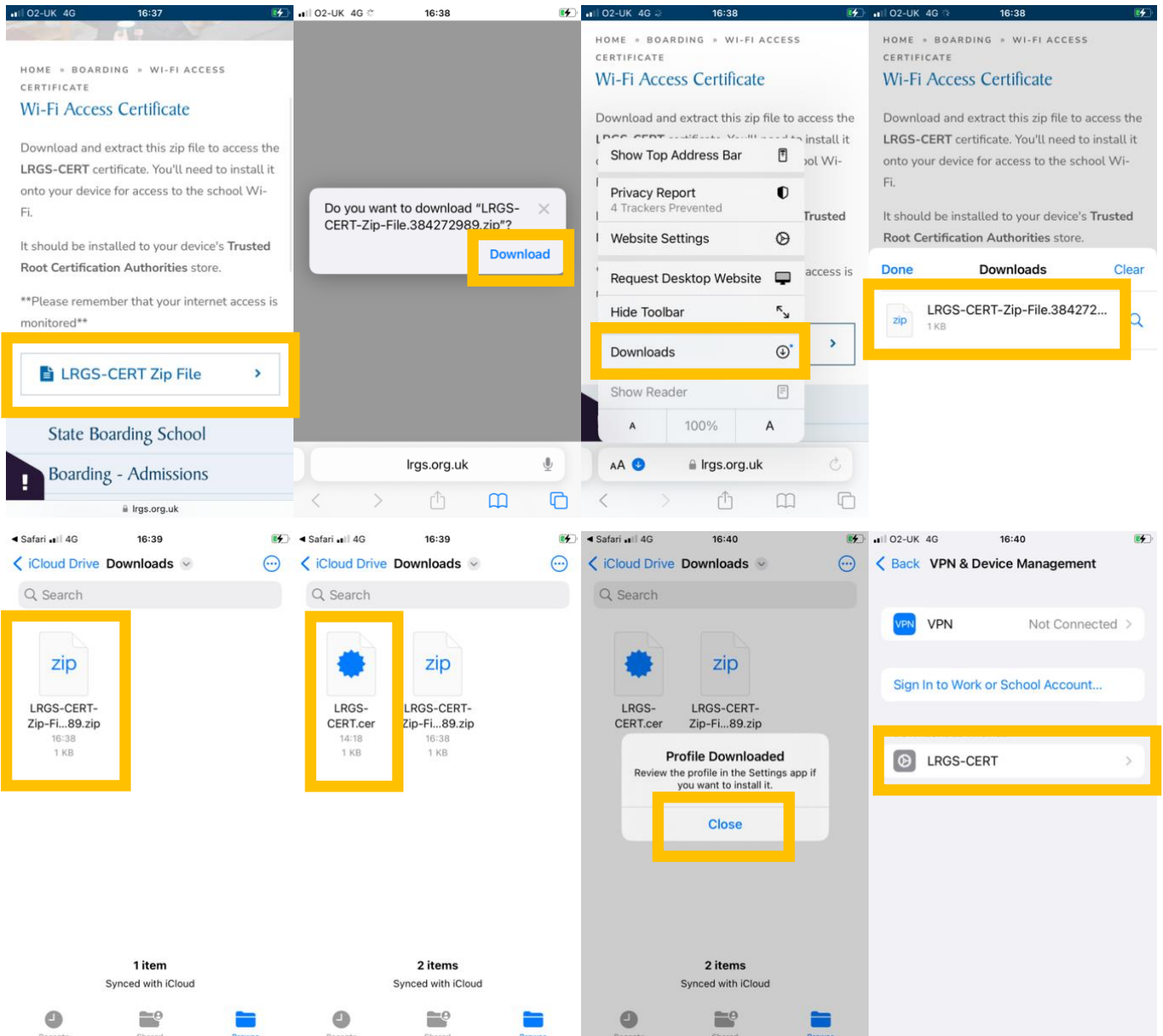

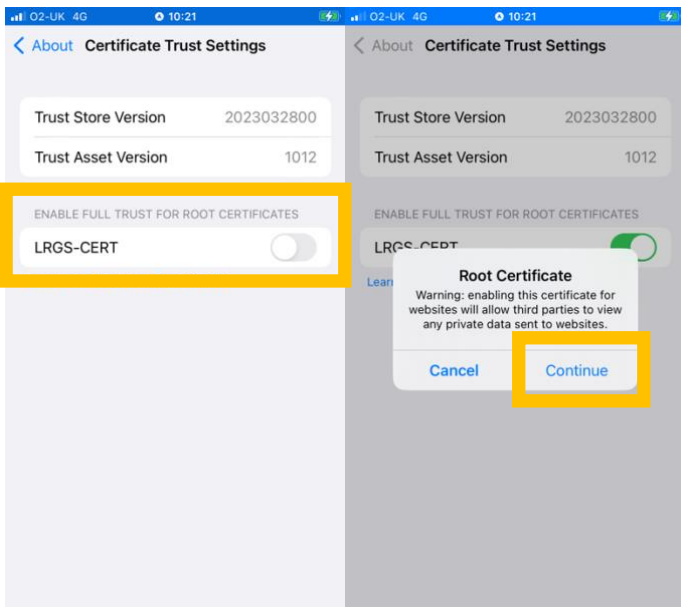
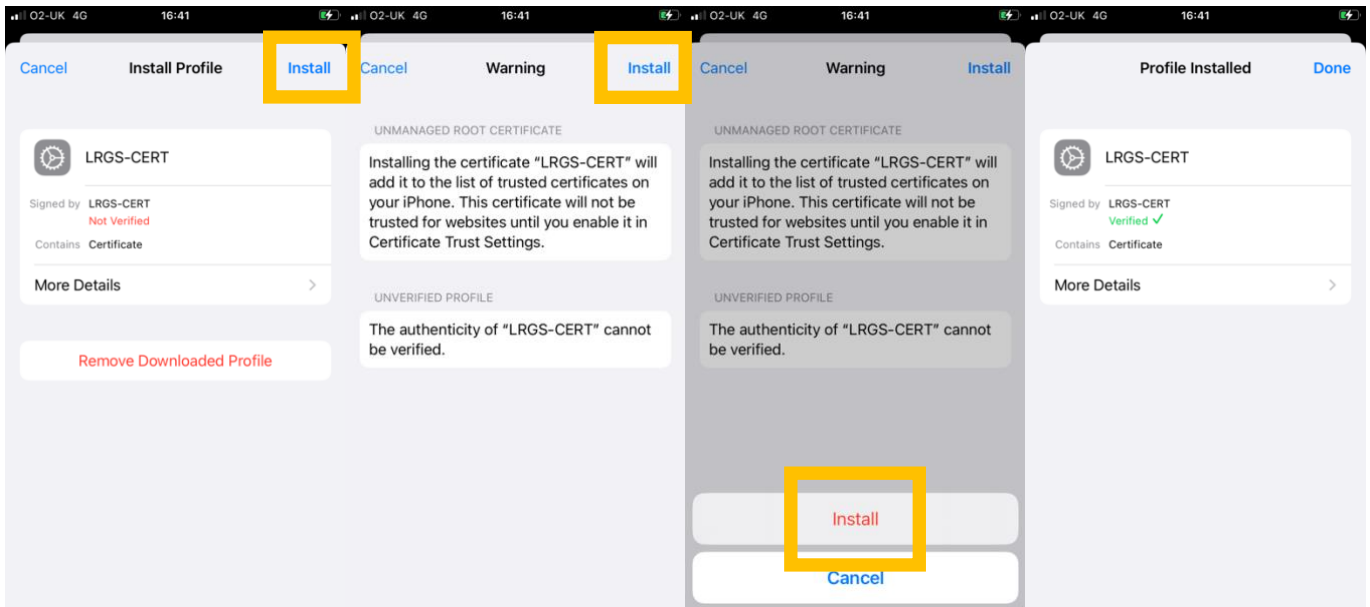

## Apple Mac/OSX Devices

### Steps to Install a Certificate on Apple Mac/OSX

To add certificates to a keychain using Keychain Access on Mac follow the instructions on link:

<https://support.apple.com/en-gb/guide/keychain-access/kyca2431/mac>

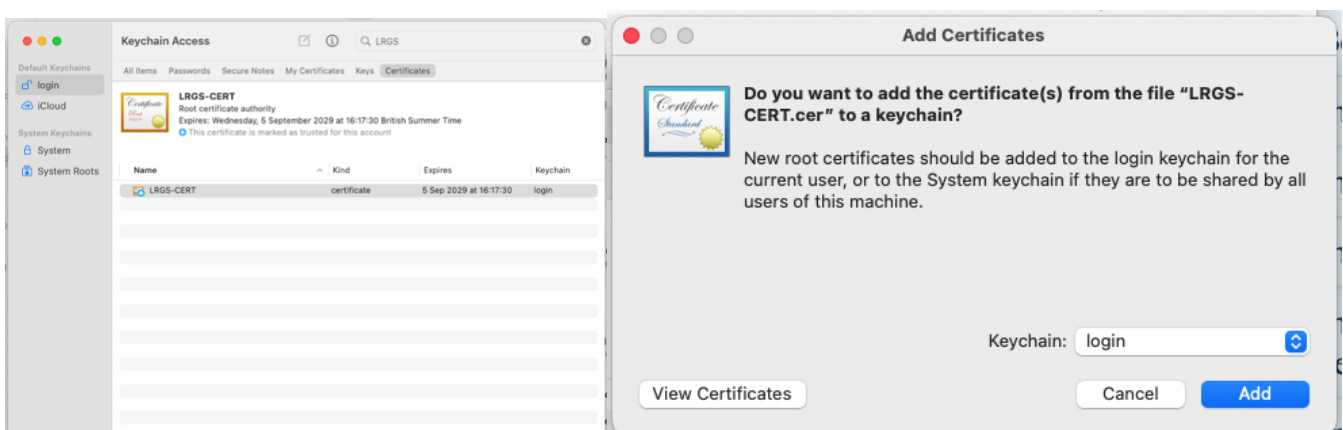

# Android

## Steps to Install a Certificate on Android

1. **Download the Certificate:** Save your certificate file (e.g., .crt, .cer,) to your phone's internal storage or SD card.
2. **Extract** the downloaded certificate file
3. **Access Settings:** Open your device's **Settings** app.
4. **Navigate to Security:** Go to **Security > More Settings** (or "Encryption & Credentials").
5. **Install Certificate:** Tap **Install a certificate** or **Install from storage**.
6. **Select Certificate Type:** Choose the type, typically **CA Certificate**.
7. **Confirm Warning:** Acknowledge the security warning by selecting "Install anyway".
8. **Locate File:** Find the downloaded file on your device and select it.
9. **Enter Credentials:** If prompted, enter your device PIN, password, or key store password.

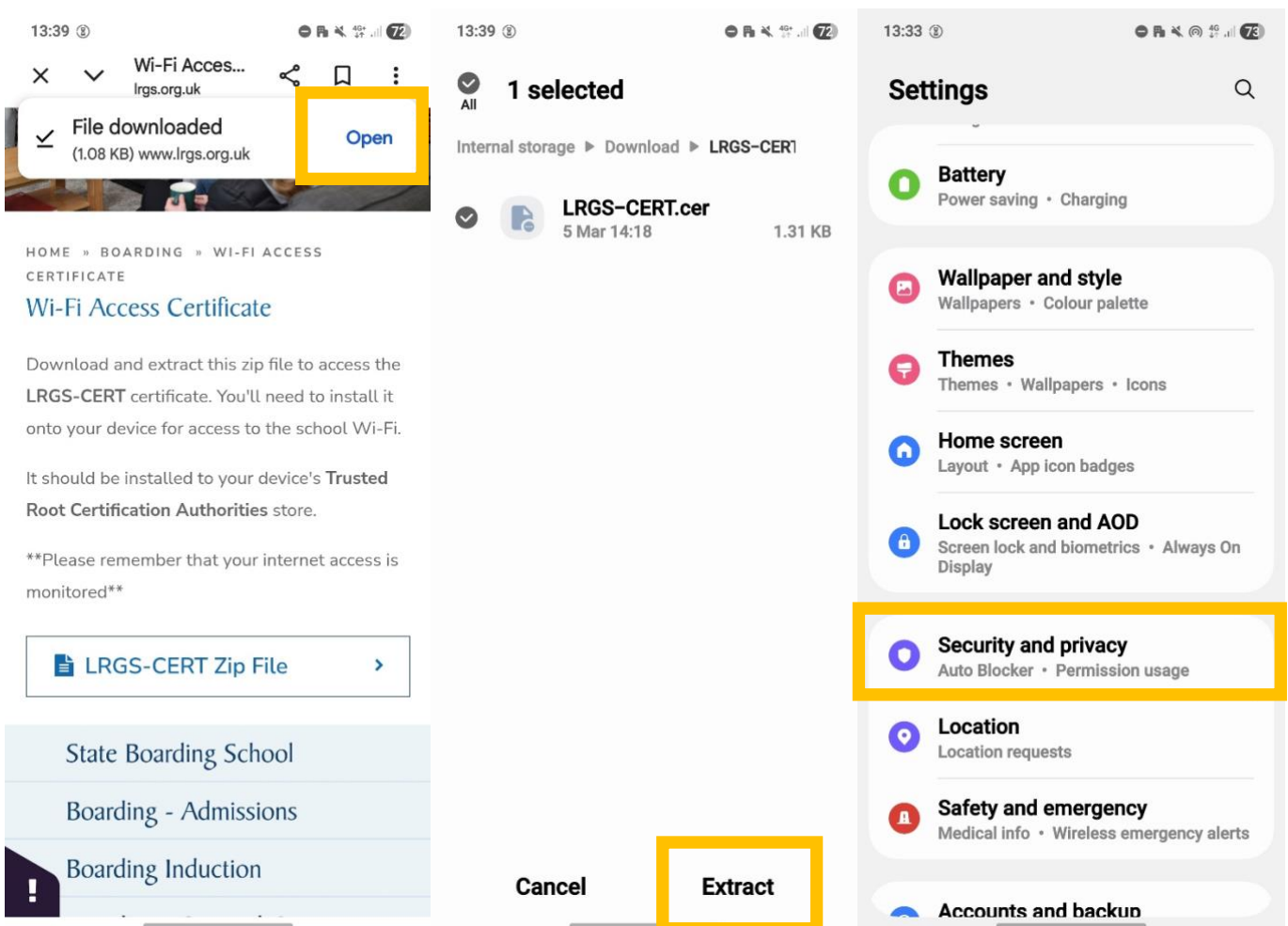

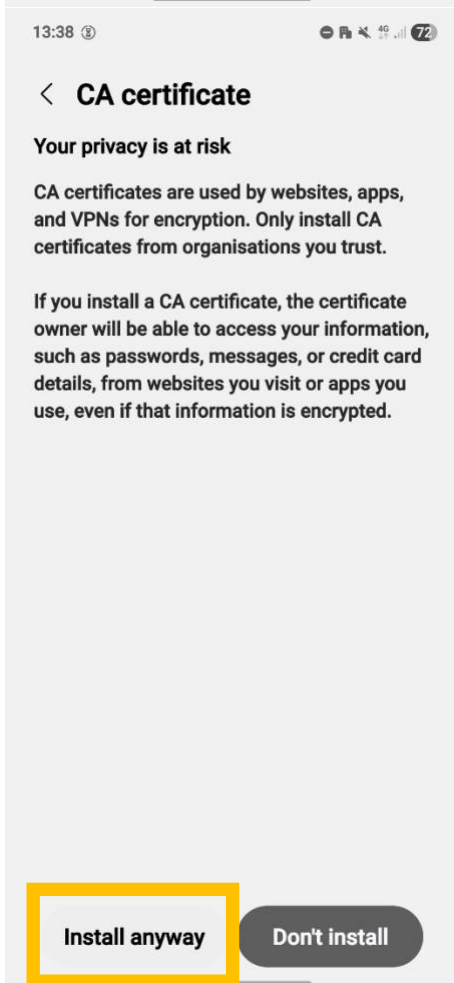
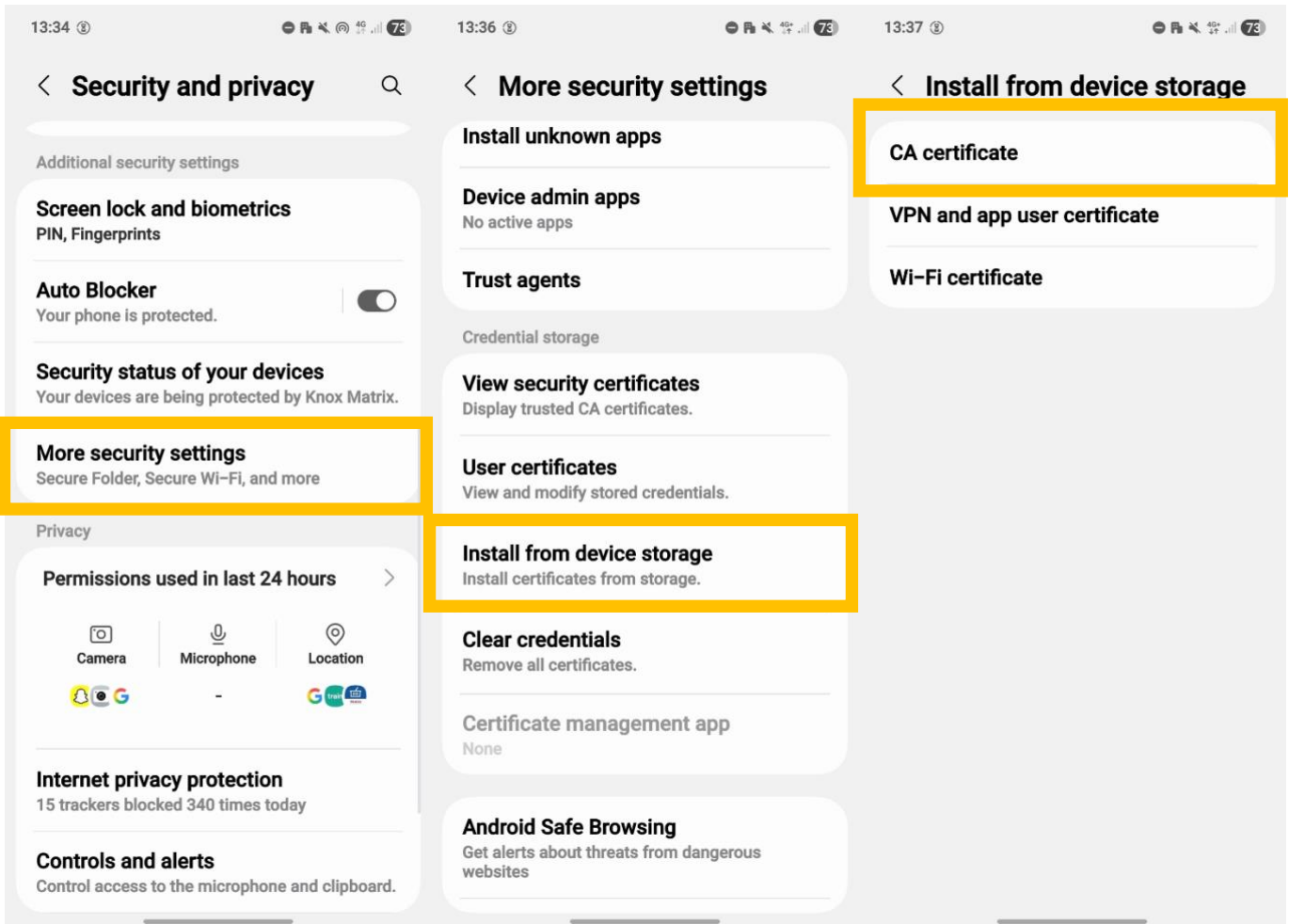

# Microsoft Windows

## Steps to Install a Certificate on Microsoft Windows

1. **Download and extract** the file from the website
2. **Open the File:** Locate your certificate file (e.g., `.crt` or `.cer` ) and double-click it.
3. **Install Certificate:** Click **Install Certificate...**
4. **Store Location:** Choose **Local Machine** (requires admin rights) for system-wide trust, or *Current User* for just your account, then click **Next**.
5. **Place Certificate:** Select **Place all certificates in the following store** and click **Browse**.
6. **Select Folder:** Choose **Trusted Root Certification Authorities** and click **OK**.
7. **Finish:** Click **Next** then **Finish**.

